

PressureGuard® Air Renewal Easy as 1-2-3

HOW: Add air, then insert auto adjust valve to bring mattress to ideal level.

WHY: Maximizes comfort and effectiveness.

WHEN: For best results, perform an air renewal at least every six months.

1. Prepare Pump

- Remove nozzle tip from pump handle and attach inflation nozzle to end of pump.



- Place nozzle marked "IN inflate" onto tip.

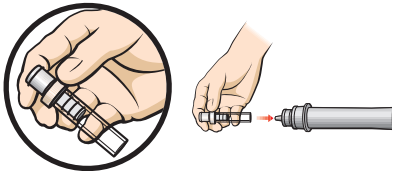

Note: Your kit may have an additional nozzle with a black tip which is for a PressureGuard II mattress. You may discard this item.

2. Add Air

- Lift cover flap. With user off mattress, insert the inflation nozzle into inflation port until it clicks.
- Pump in at least four strokes of air.

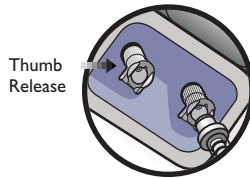
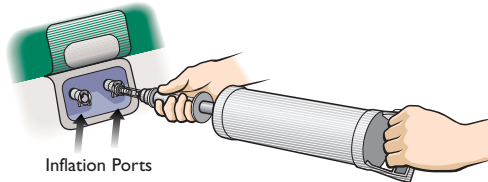

- Disconnect pump from the port by depressing the silver thumb release.
- Repeat for other port.

3. Insert Auto-Adjust Valve

- Insert the white end of the "OUT auto-adjust" valve into port until it clicks.
- Air will escape automatically to ideal setting (you will be able to feel air escaping).
- Remove when you no longer feel air escaping from valve.
- Repeat for other port.

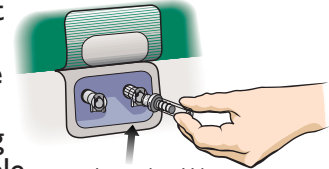

NOTE: Failure to auto-adjust after adding air will leave mattress over-inflated. This could damage mattress.

Please call our customer service office for any questions. Monday-Friday, 8 a.m.-5 p.m.
(800) 888-6752 or e-mail www.spanamerica.com email: info@spanamerica.com

SPAN-AMERICA
THE MAKERS OF GEO-MATT®